

SOUTH MELBOURNE 412/338 Kings Way

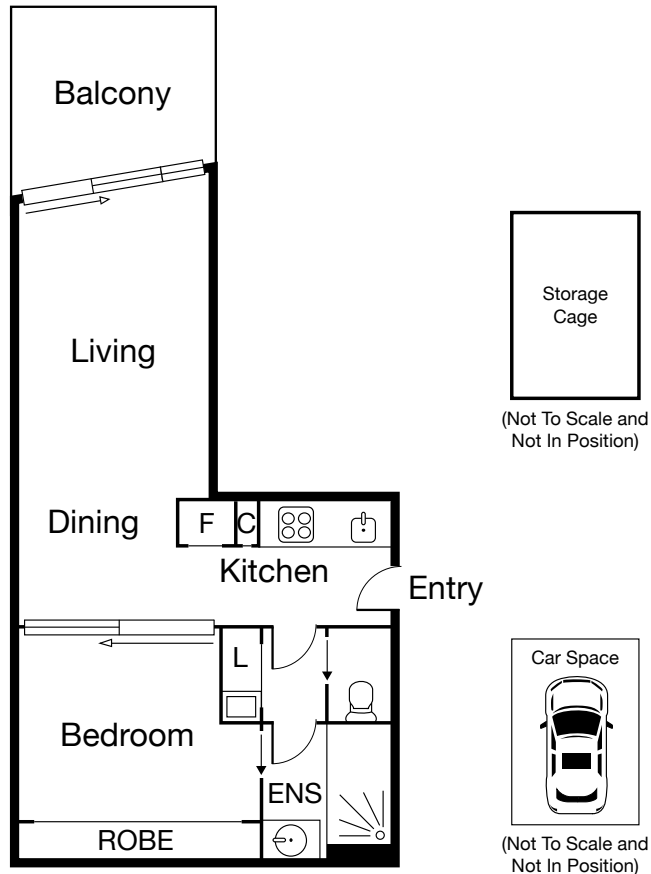

**CAYZER**

# SOUTH MELBOURNE 412/338 Kings Way



## LOCATION, SOPHISTICATION & OPPORTUNITY

- Located in the beautifully maintained executive "Silverleaf" building
- Secured car space on title and impressive storage cage
- Moments from transport, bars, restaurants and Crown Entertainment Complex

Located only a stone's throw from Melbourne's CBD. This modern apartment is located on the fourth floor, comprising a king size bedroom enhanced by a two-way contemporary bathroom, ample robe space and fresh timber floors. A chic stone kitchen, with all the utilities through to an open plan meals and living room to a private oversized, functional terrace. Completed with electricity and gas supply and fully ducted heating and cooling unit for your comfort. Fantastic for the first home buyer or investor.



PRIVATE SALE

Inspection As advertised or by appointment

Contact Brocke Hambrecht 0466 599 724  
Jordan Gravestein 0448 250 193  
Michael Szulc 0417 122 809

MeL Ref 57 J2

Website 412-338kingswaysouthmelbourne.com



Interactive Floorplan

# CAYZER

Albert Park 330 Montague Street 03 9699 5999  
Port Melbourne 310 Bay Street 03 9646 0812

cayzer.com.au

Every care has been taken to ensure the information contained in this document is accurate. The diagrams/plans are a representation only and are not to scale. Interested parties should seek independent legal advice. Cayzer Real Estate Pty Ltd does not accept any responsibility or liability as a result of the information provided in this document. If your property is currently listed for sale with another agent, please disregard this notice. | Cayzer Real Estate Pty Ltd | CRE20255-083 040917